

# MIL. SPEC SWAGE STUD, LEFT HAND, UNF THREAD STAINLESS STEEL

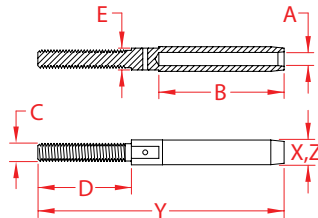

Made in  
USA



Precision  
Machined



ITEM	A (wire)	B	C	D	E	X (height)	Y (length)	Z (width)	WT (lb)	PACKAGING TYPE	EACH (qty)	INNER (qty)	CARTON (qty)	UPC
MS21259-2LH	1/16"	1.04"	0.14"	1.05"	0.16"	0.16"	2.47"	0.16"	0.01	POLYBAG	1	10	500	791506019466
MS21259-3LH	3/32"	1.26"	0.19"	1.20"	0.19"	0.22"	2.88"	0.22"	0.02	POLYBAG	1	10	500	791506019480
MS21259-4LH	1/8"	1.51"	0.25"	1.38"	0.25"	0.25"	3.33"	0.25"	0.03	POLYBAG	1	10	500	791506019503
MS21259-5LH	5/32"	1.76"	0.25"	1.38"	0.25"	0.30"	3.63"	0.30"	0.04	POLYBAG	1	5	200	791506019527
MS21259-6LH	3/16"	2.01"	0.31"	1.45"	0.31"	0.36"	4.00"	0.36"	0.07	POLYBAG	1	5	200	791506019541
MS21259-8LH	1/4"	2.51"	0.38"	1.75"	0.44"	0.49"	4.94"	0.49"	0.17	POLYBAG	1	5	100	791506019565
MS21259-10LH	5/16"	3.01"	0.50"	2.00"	0.63"	0.64"	5.84"	0.64"	0.37	POLYBAG	1	1	50	791506019428
MS21259-12LH	3/8"	3.51"	0.56"	2.25"	0.69"	0.70"	6.66"	0.70"	0.50	POLYBAG	1	1	50	791506019442

**NOTE:**  
**THESE FITTINGS MEET MIL SPEC #MS21259 AND HAVE MET ALL QUALITY AND TESTING REQUIREMENTS PER MIL-DTL-781**  
**AND ARE APPROVED FOR LISTING IN QPL-781. ALL THREADS ARE "UNF". MACHINE SWAGE ONLY.**  
**ALL DIMENSIONS ARE NOMINAL (+/- 3%) AND ARE SUBJECT TO CHANGE WITHOUT NOTICE.**